

67,000 SF (Divisible) Industrial on 9.8 Acres - FOR LEASE

5301 W Madison St, - Phoenix, AZ

\$14,000 /Mo./IMG



FEATURES:

- Buildings: +/- 67,000 SF (Divisible)
- Office: 4,000 SF - New Office
- Lot Size: 9.80 Acres (Fenced)
- Clearance: 15' - 30'
- Zoned: A-2 (City of Phoenix)
- Parking: 188 (20 Covered)

1702 E Highland Ave | Suite 120, Phoenix, AZ 85016



For more information please contact:

Benjamin Johnson
Ben.johnson@daumcommercial.com
(602) 575-2318

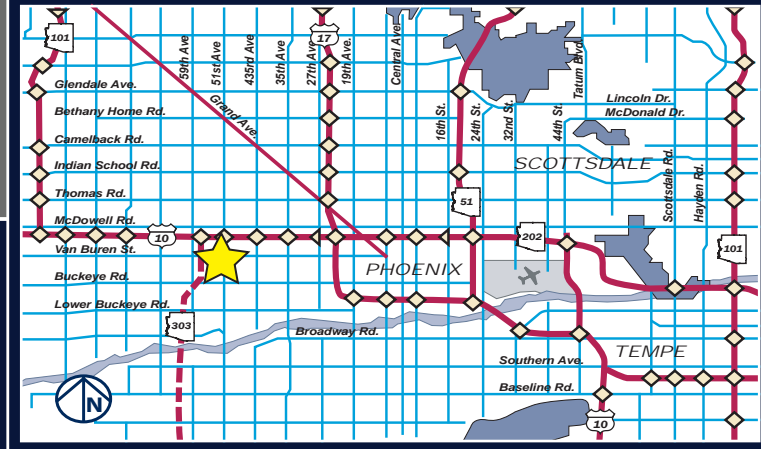

The info contained in this brochure has been obtained from sources deemed reliable, but has not been independently verified by DAUM. While we do not doubt its accuracy, we make no guarantee or warranty as to its completeness or accuracy. © DAUM * ADOT 2005 - <http://tpd.azdot.gov>